

**HOTA** HOME  
OF THE  
ARTS



**LAKESIDE ROOM**  
VENUE INFORMATION

**GOLDCOAST.**<sup>TM</sup>

[HOTA.COM.AU](http://HOTA.COM.AU)



# Welcome to HOTA, Home of the Arts

In tropical parklands with the Surfers Paradise skyline as the backdrop, HOTA, Home of the Arts is a contemporary cultural precinct where art meets life.

HOTA is the Gold Coast's home of live performances, lake side strolls, stargazing, cinema-watching, art, conversation and new ideas.

Offering several performance and event spaces HOTA is the perfect venue for your next theatre production, live music performance, graduation or VIP event experience.



# LAKESIDE ROOM

An airy, versatile space with great views of our

lake, the new HOTA Green Bridge and Surfers

Paradise.

With a huge open floor area, bookended by an 8m wide proscenium arch stage at one end and an outdoor terrace at the other, we love nothing more than throwing the doors open and spilling out onto the outdoor area.

Live music, corporate gala dinners, spectacular cabaret, trade shows, conferences and elegant cocktail events – they’ve all taken place in this space.

With a large indoor foyer, three bars, a removable wall, two dressing rooms and the state of the art lighting, sound and visual technology you’d expect from us, no matter what you want to create, we can make it happen in this room.

And to add a special twist to the experience your guests can arrive by private coach or by boat, in true Gold Coast style.

## Capacity

### FULL ROOM

• Theatre	500
• Banquet	350
• Cocktail	550
• Cabaret	280
• Floor size	368m2

### HALF ROOM

• Theatre	200
• Banquet	150
• Cocktail	250
• Cabaret	120
• Floor size	182m2

### OUTDOOR TERRACE

• Cocktail	100
• Floor size	91m2

## Availability

7 days a week





# Lakeside Room

## Features

- Stage Dimensions: 7940mm W x 7900mm D x 830mm H
- Dual projectors and screens (1884mm x 3015mm) stage end
- Centre stage projector
- Data projector and screen in Lakeside Terrace
- Performance quality audio and lighting system
- Large covered east facing terrace with a stunning view
- Direct access to the Evandale Lake and parklands for additional entertainment such as fireworks or team building activities.
- Removable wall which can be used to divide the room at half way or  $\frac{3}{4}$  position
- Full room black draping (when requested)
- 3 x fixed bar areas
- Large internal foyer with bar and amenities
- Direct bus/car access via private road
- Ramp access and driveway adjacent for easy bump in/out
- Lift and wheelchair accessibility
- 2 x dressing rooms for up to 4pax each
- Catering and beverage service provided in house by the HOTA Events team
- Close proximity to the HOTA dock for boat arrivals









# General Information

## Food and Beverages

Whatever you have in mind – from refined plated options, exceptional canapes or a casual buffet – we can create

a menu that your guests won't stop talking about.

You can also sit indoors or out at HOTA Café for coffee, snacks, and meals.

## Parking and Access

Plenty of parking is available right outside our doors, including free four-hour parking from 8am-5pm. Additional all day paid parking is also available in the carpark adjacent to the river.

There are plenty of other ways to get here too. Your guests can arrive by coach, by public transport, private boat or even by ferry to our very own HOTA dock.

Or your guests can walk across the new HOTA Green Bridge from Chevron Island for an arrival experience like no other.

## Internet

It's easy to stay connected at HOTA with free wifi available.

## Curfews

We are licensed until 12am.

## Smoking

As with everywhere smoking is strictly prohibited inside the building.

## Other venue options at HOTA

No matter the size or scale of your event, we've got an option for you. Ask us about our:

- Outdoor Stage
- Panorama Room
- Basement

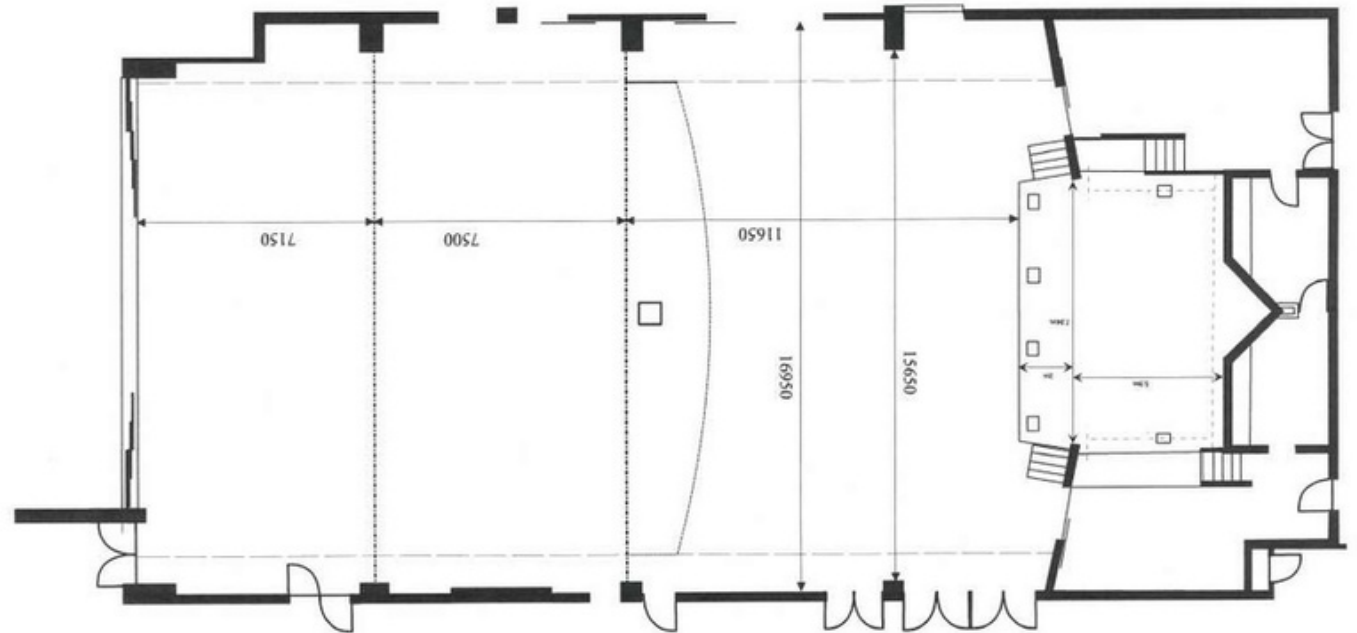

# Contact

For Performance Hire enquiries:  
[venuebookings@hota.com.au](mailto:venuebookings@hota.com.au)

Meetings and Event enquiries:  
[events@hota.com.au](mailto:events@hota.com.au)